



Royal Irish

The Irish Soldier in Service to the Crown

An acre of Ireland in the heart of the British Isles

Irish Infantry Grove Appeal

.....

The National Memorial Arboretum is a special place which now honours service not only with living trees but also with sculpture and monumental art.

In this context the Irish Infantry Grove, dedicated in May 2000 and commemorating all who have served and continue to serve in the Irish Infantry Regiments of the Line, has become unremarkable. Visitors to the Arboretum rarely stop at the grove.

We need your help to change this.



— THE GROVE TODAY —

A project has been launched to develop the Irish Infantry Grove in a way which will establish it as a focus for all with a connection to the Irish Infantry Regiments of the Line. This development will also achieve the original premise of "... an acre of Ireland in the heart of the British Isles ...".

Visit the National Memorial Arboretum on Google Earth. The Irish Infantry Grove lies 52° 43' 37" N 1° 43' 37" W. It is unremarkable.

Imagine now a paved map of the island of Ireland on the same site with trees surrounding but not hiding it. Immediately the connection of the site with Ireland is made.

The physical visitor to the Irish Infantry Grove will find the paved map marked with the Regimental Depot of each of the Irish Infantry Regiments commemorated; the depot locations illustrated by a stone plaque engraved with the Regiment's badge or crest. Surrounding the paved map trees and shrubs, all of Irish origin, providing a shade dappled environment in which visitors can rest on stone benches and contemplate.

This project will cost in the region of £80,000 to realise. On the face of it a huge sum, in reality less than £5 from every member of the Regimental Associations of the Irish Infantry Regiments of the Line and of The Royal Irish Regiment.

**Please help to put the Irish Infantry Regiments
back into the heart of Great Britain.**

Proposed design for the Irish Infantry Grove

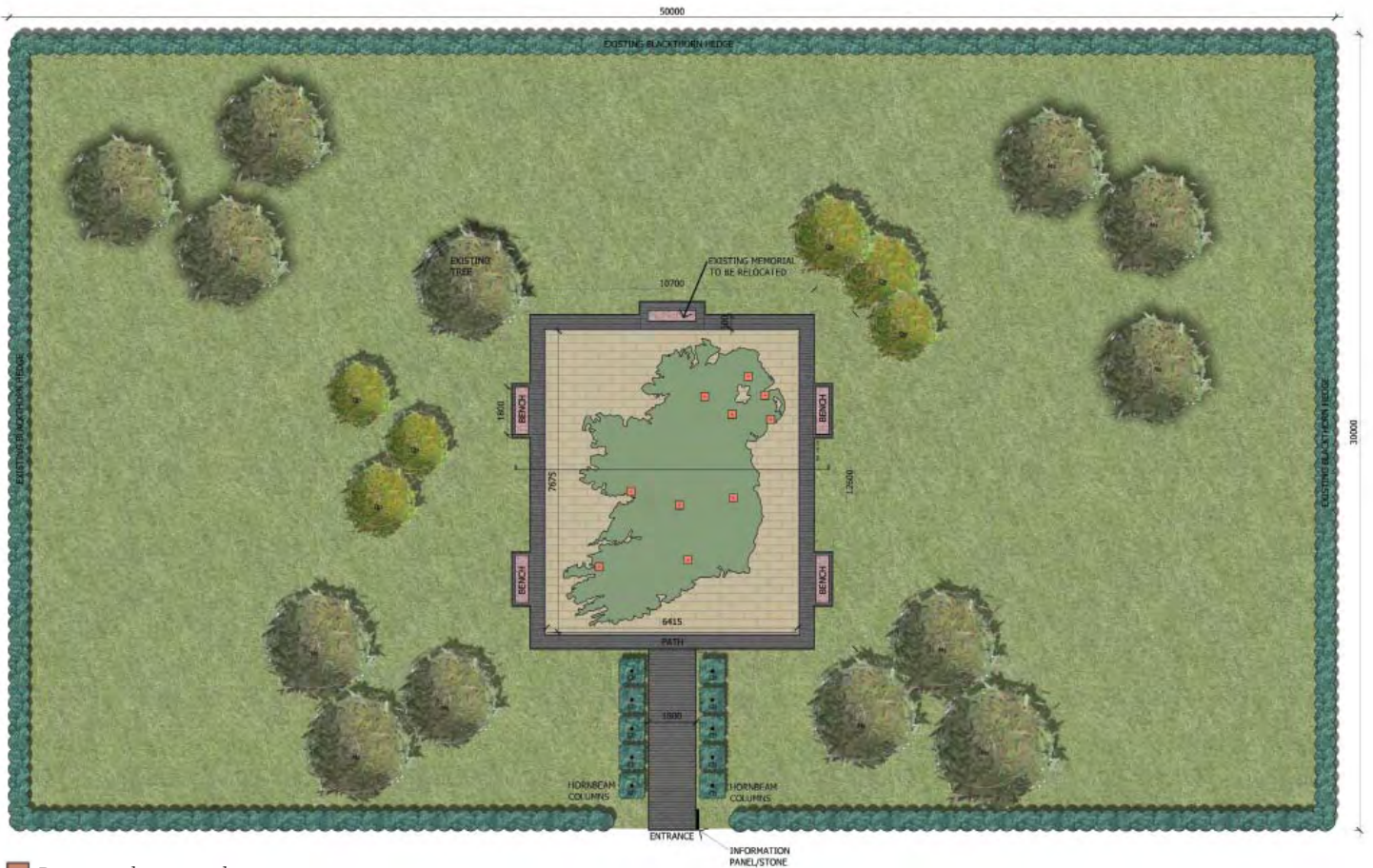

■ Regiment location plaque



Regimental badges will be engraved on stone plaques to be located at each Regiment location on the paved map of Ireland.

Donate on line at www.sponsorme.co.uk/royalirish or by cheque (Euro or Sterling) made out to Central Bank R Irish:

Irish Infantry Grove Appeal

Regimental Headquarters, The Royal Irish Regiment, Palace Barracks, BELFAST, BFPO 806

UK tax payers are invited to complete the attached Gift Aid form so that tax on donations can also be claimed on your behalf.